

1 Place the media onto the media holder

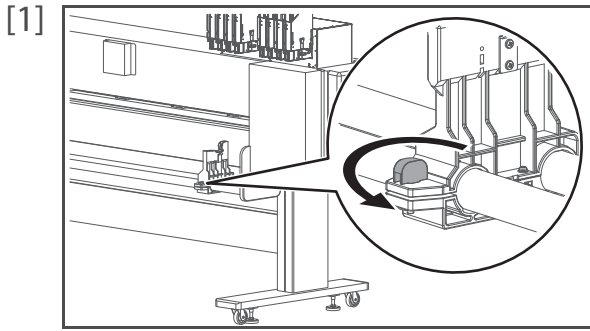

Twist the knob bolt on the right side of the media holder anticlockwise to loosen.

[2] Place the roll media onto the left media holder. Carefully and gently place it on the holder.
(If torque is enabled)

- ①: When looking from the left side, check that the protrusion on the roller shaft guide plate is fitted into between two protrusions on the flange end cap.
- ②: When looking from the rear side of the printer, check that the flange end cap is properly placed on the protrusion on the roller shaft guide plate.

Important!

Do not drop or apply excessive impact while placing the media. This will cause damage to the part.

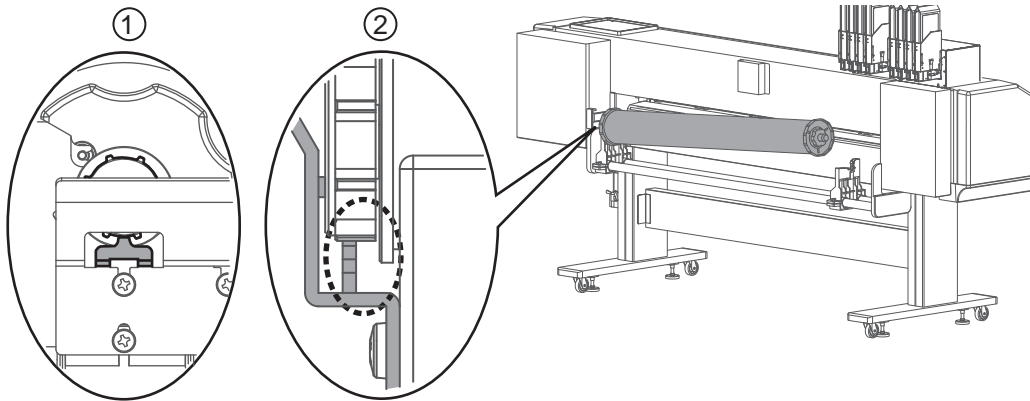

(If torque is disabled)

- Check that the stopper on the shaft is fitted into the slit as shown in the illustration (not on the media holder).

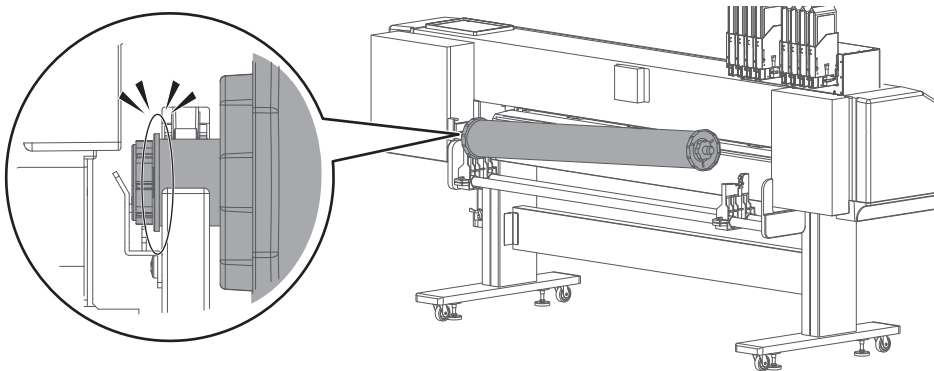

Important!

When you adjust the position of the media holder (left), do not move it more than 450 mm away from the left-hand end. The printer will not be able to detect media.

- [3] Slide the right side of the media holder to place the right side of the flange onto the holder.
Place the roll media onto the right media holder. Carefully and gently place it on the holder.
(If torque is enabled)

- ①: When looking from the right side, check that the protrusion on the roller shaft guide plate is fitted into between two protrusions on the flange end cap.
- ②: When looking from the rear side of the printer, check that there is a gap between the protrusion on the roller shaft guide plate and stopper on the shaft.

 **Important!**

- **Do not drop or apply excessive impact while placing the media. This will cause damage to the part.**
- **If the stopper gets contact with the guide plate as "No Good" example below, it may cause damage to the part.**

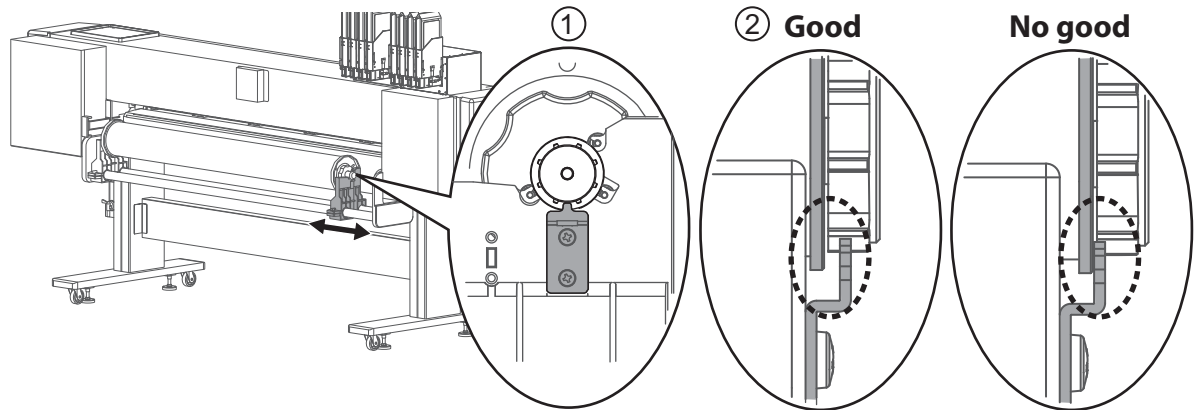

(If torque is disabled)

- Check that the stopper on the shaft is fitted into the slit as shown in the illustration (not on the media holder).

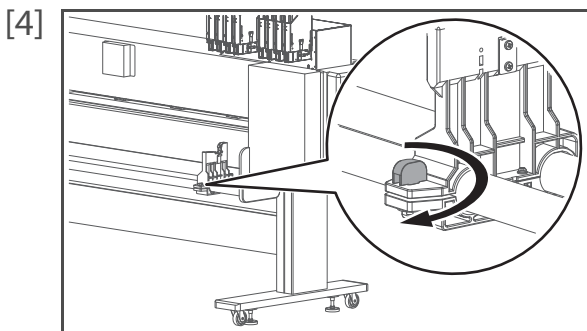
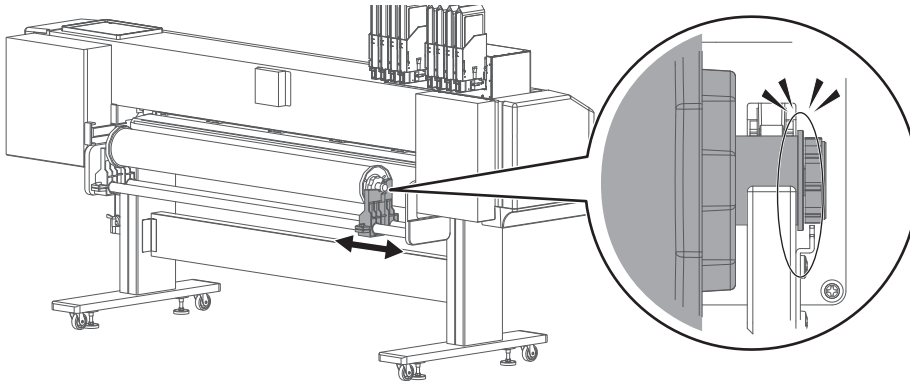

Twist the knob bolt on the right side of the media holder clockwise to tighten.

4. Load the media into the printer

[1] Check that the printer is powered on.

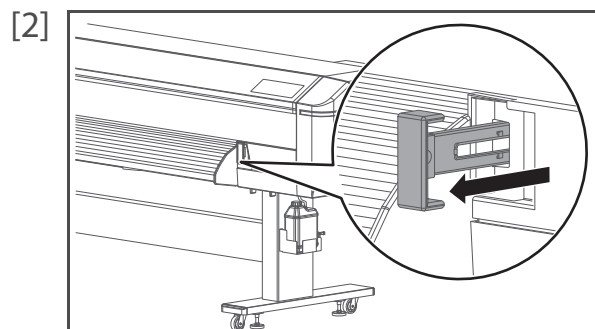

From the front side of the printer, fully pull the media feed lever towards you to release the pressure rollers.

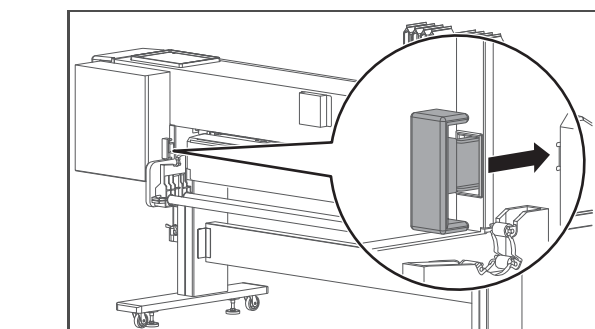

You can access to the media feed lever from the rear side of the printer.

- To release the pressure rollers, push the lever as far as it goes.

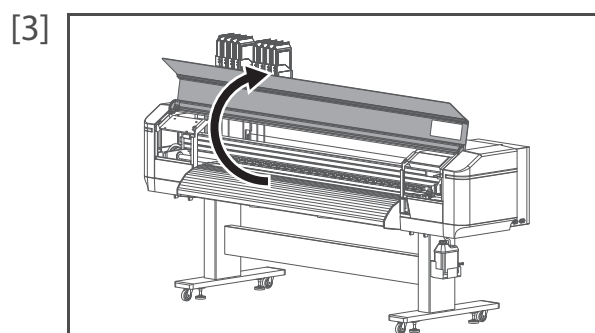

Open the front cover.

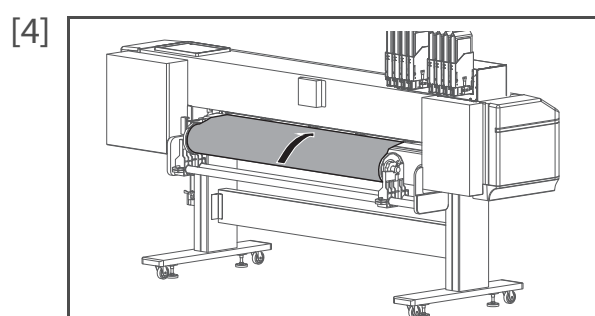

From the rear side of the printer, insert the front edge of the media into the media slot.

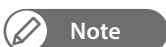

Note

Before inserting, rewind the media properly.

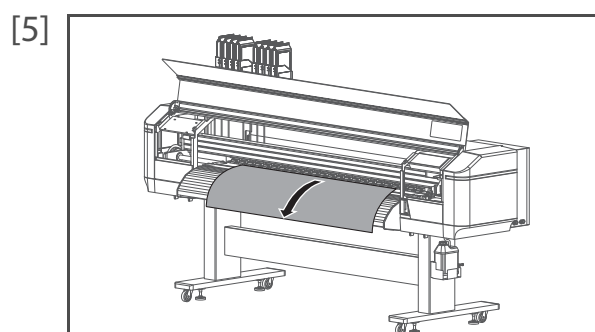

From the front side of the printer, pull the media for approximately 1 m.

- [6] While one person holds the front edge of the media, the other person turns the flange to slightly rewind the media onto the roll to remove warp or skew.

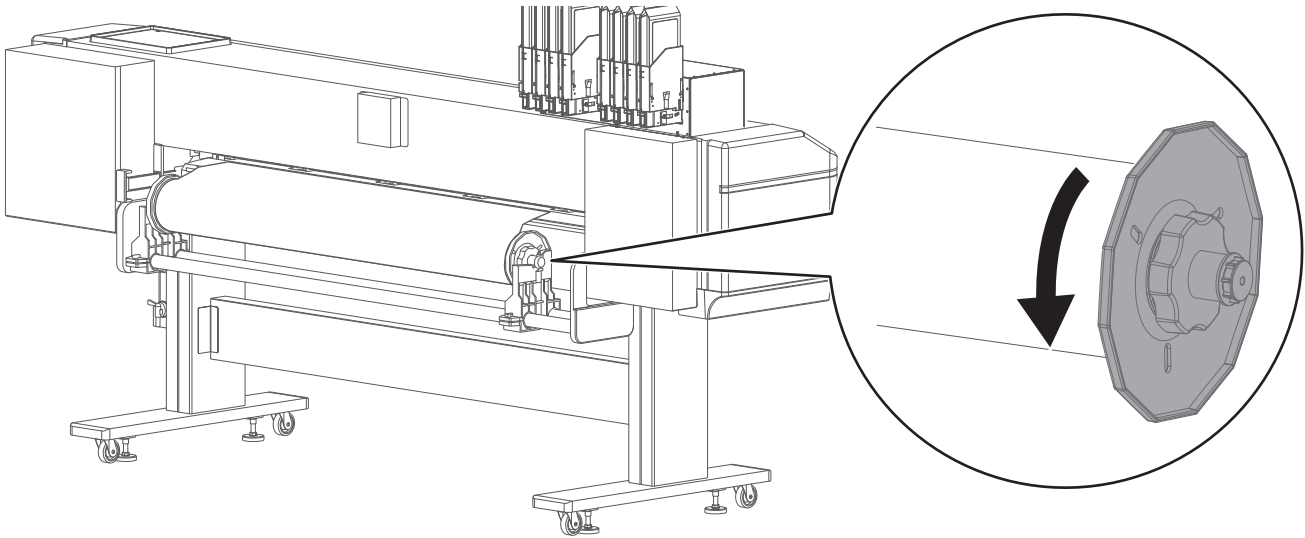

 Note

If you remove your hands from the front edge of the media while rewinding, the media can be removed from the media slot.

- [7] Check that the right-hand edge of the media is located at the left side of the media guide line. If not, print quality can be affected.

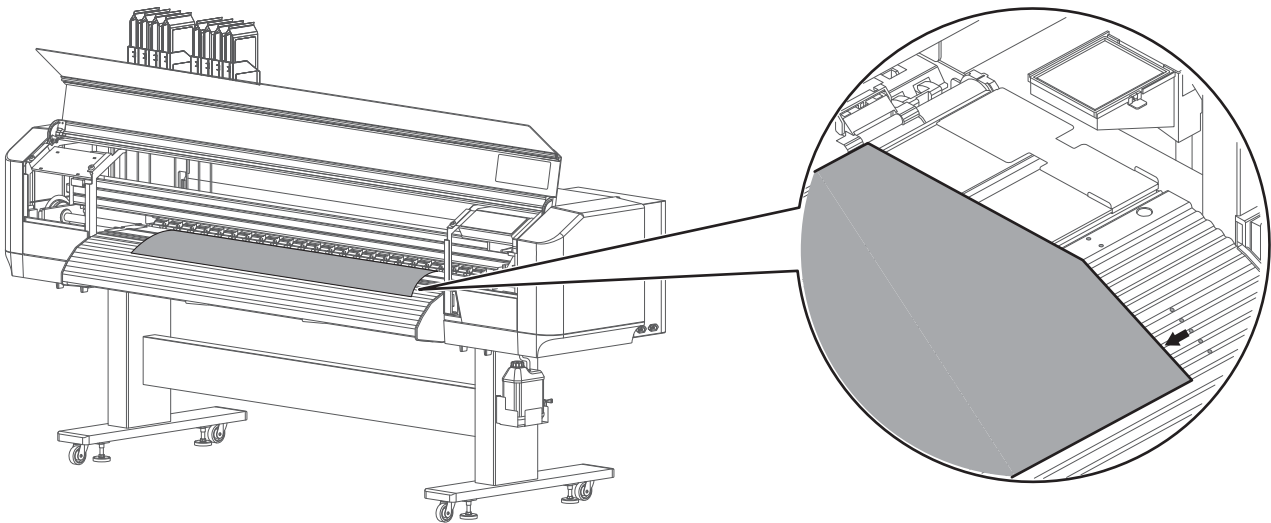

- [8] If needed, use a slide lock lever on the pressure rollers to individually cancel or reduce the pressure.

 Operation Manual "Canceling or reducing pressure rollers individually"

5. After loading the media...

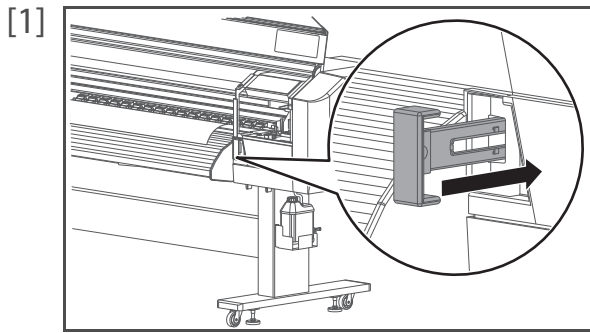

From the front side of the printer, push the media feed lever to hold the media flat with pressure rollers.

 **Note**

Using this lever, the pressure applied to the rollers can be changed between High and Normal. Normally push the lever until it clicks to apply normal pressure.

 Operation Manual "Changing holddown pressure using media feed lever"

[2] Check that the pressure rollers hold down the both edges of the media properly.

- If it holds as a "No Good" example, pull the media feed lever towards you as much as possible, then adjust the position of the left or right side of the media holder until the both edges of the media are held down properly (see ["Place the media onto the media holder" P. 29](#) for more details).

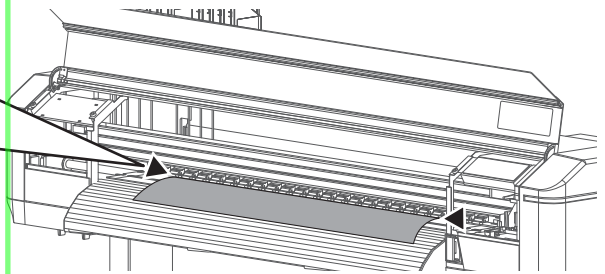
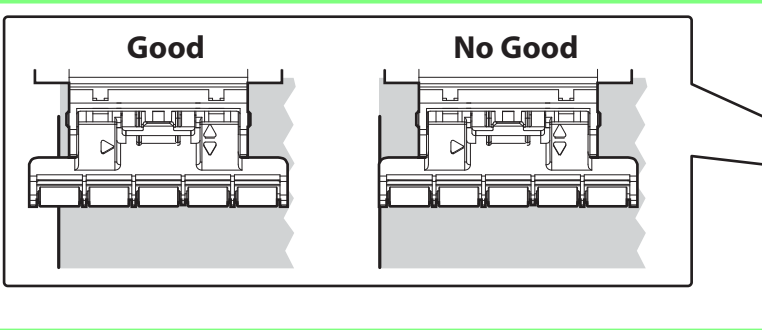

[3] Place the edge holders on both edges of the media.

 **Important!**

In the default setting, the printer starts printing with 5 mm margin on the sides. Set the side margin to 10mm or more according to the following procedure because the overlapping part of the edge holder and media may be stained with ink.

